

# ECD-1000

## 16-Channel Megapixel H.264 Video Decoder



- Special decoder for large TV panels away from video control room
- Video source up to 10-Megapixel supported
- HDMI output with 1080p resolution
- BNC output for NTSC or PAL standard
- Easy Installation with surface, VESA or pole mounts
- USB port for mouse control
- Powered by PoE Class 3 / DC 12V

### PHOTO INDICATION

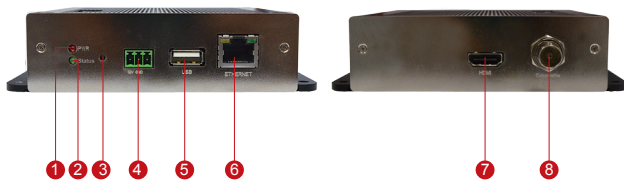

- |                      |                                   |
|----------------------|-----------------------------------|
| 1 Power LED          | 5 USB Port                        |
| 2 System Ready LED   | 6 Ethernet Port                   |
| 3 Reset Button       | 7 HDMI Port                       |
| 4 DC 12V Power Input | 8 Analog Video Output (Composite) |

### DIMENSION DIAGRAM

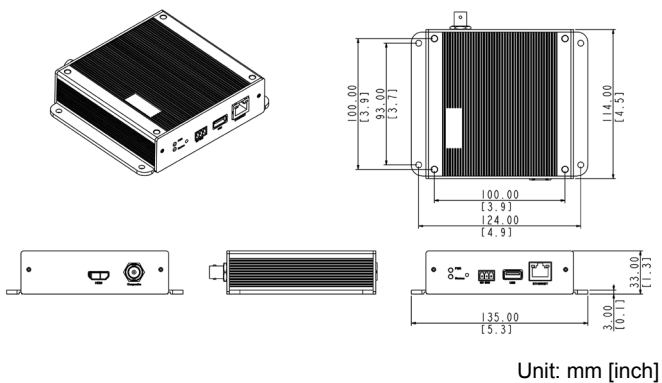

### MOUNTING SOLUTIONS

Surface Mount | Accessories not required

Pole Mount (Bundled)



VESA Mount

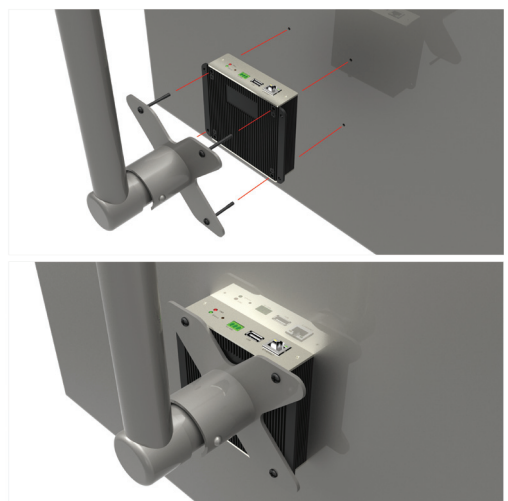

**PRODUCT SPECIFICATION****ECD-1000****• General**

Device Type	Video Decoder
Number of Channels	16
Max. Networking Throughput	40 Mbps

**• Video Source**

Resolution	Up to 10 Megapixels
Frame Rate	1~30 fps
Compression	H.264

**• Video Output**

Video Layout	1, 2, 4, 9, 12, 16, 1+5, 1+7, 1+12, 2+4, 2+8
Output Standard	HDTV standard up to 1080P, 25/30/50/60Hz; NTSC standard (equivalent to 720 x 480); PAL standard (equivalent to 720 x 576)
Max. Display Resolution	Local: up to 2 Megapixels ; Remote: up to 10 Megapixels

**• Network**

Protocol & Service	TCP, UDP, IP, HTTP, RTP, RTSP, ICMP, ARP, UPnP
Ethernet Port	1, Ethernet (10/100 Base-T), RJ-45 connector
Security	Password protected user levels

**• Alarm**

Alarm Trigger	Network loss, Video loss
Alarm Response	Beep

**• Interface**

Analog Video Output	1, BNC connector
HDMI Output	1, HDMI Type A
USB	1, USB 2.0

**• General**

Power Source / Consumption	PoE Class 3 (IEEE802.3af) / 8.5 W DC 12V / 7 W
Weight	566 g (1.25 lb)
Dimensions (W x H x D)	135 mm x 114 mm x 33 mm (5.3" x 4.5" x 1.3")
Bundled Accessories	Bracket (mount for 1"~2" diameter pipe); Power adapter
Mount Type	Surface, Pole, VESA (10 cm x 10 cm)
Operating Temperature	0°C ~ 50°C (32°F ~ 122°F)
Operating Humidity	10% ~ 85% RH
Approvals	CE (EN 55022 Class B, EN 55024), FCC (Part15 Subpart B Class B)

**• Integration**

Unified Solution	Fully compatible with ACTi cameras and encoders
Firmware Access Browser	Microsoft Internet Explorer 9.0 or newer