

# HF-HA-1S series, 1/2"-2/3", 6.2μm, 1.5MP



- Wide range of focal lengths with 8 models
- Compact design with an external diameter of 29.5mm\*
- Large maximum aperture
- Short Minimum Object Distance

\* HF75HA-1S has a diameter of 31.5mm



	Anti Shock & Vibration DF6HA-1S	Anti Shock & Vibration HF9HA-1S	Anti Shock & Vibration HF12.5HA-1S	Anti Shock & Vibration HF16HA-1S
Focal length [mm]	6	9	12.5	16
Iris range [F. no]	F1.2-F16	F1.4-F16	F1.4-F16	F1.4-F16
Angle of view	57.3°×43.8°(1/2")	53.3°×40.5°(2/3")	39.2°×29.4°(2/3")	30.5°×22.9°(2/3")
Working Distance*1 [mm]	∞-10	∞-40	∞-20	∞-40
Operation of focus	Manual	Manual	Manual	Manual
Operation of iris	Manual	Manual	Manual	Manual
Filter thread [mm]	M27×0.5	M27×0.5	M25.5×0.5	M25.5×0.5
Mount	C-mount	C-mount	C-mount	C-mount
Weight (approx.) [g]	50	50	40	40
Sensor size (std.)*2	1/2"(4.5μm)	2/3"(6.2μm)	2/3"(6.2μm)	2/3"(6.2μm)
Sensor size (max.)*3	1/2"(4.5μm)	2/3"(6.2μm)	2/3"(6.2μm)	2/3"(6.2μm)
TV distortion [%]	-1.84	-2.00	-1.95	-0.87
Dimension [mm]	ø29.5×36.7	ø29.5×35	ø29.5×29.5	ø29.5×29.5

	Anti Shock & Vibration HF25HA-1S	Anti Shock & Vibration HF35HA-1S	Anti Shock & Vibration HF50HA-1S	Anti Shock & Vibration HF75HA-1S
Focal length [mm]	25	35	50	75
Iris range [F. no]	F1.4-F16	F1.6-F22	F2.3-F22	F2.8-F22
Angle of view	19.4°×14.6°(2/3")	14.3°×10.8°(2/3")	10.1°×7.6°(2/3")	6.7°×5.0°(2/3")
Working Distance*1 [mm]	∞-120	∞-230	∞-500	∞-1,100
Operation of focus	Manual	Manual	Manual	Manual
Operation of iris	Manual	Manual	Manual	Manual
Filter thread [mm]	M25.5×0.5	M25.5×0.5	M25.5×0.5	M30.5×0.5
Mount	C-mount	C-mount	C-mount	C-mount
Weight (approx.) [g]	40	40	40	50
Sensor size (std.)*2	2/3"(6.2μm)	2/3"(6.2μm)	2/3"(6.2μm)	2/3"(6.2μm)
Sensor size (max.)*3	2/3"(6.2μm)	2/3"(6.2μm)	2/3"(6.2μm)	2/3"(6.2μm)
TV distortion [%]	-0.19	0.10	0.06	0.36
Dimension [mm]	ø29.5×29.5	ø29.5×29.5	ø29.5×29.5	ø31.5×48

DF6HA-1S

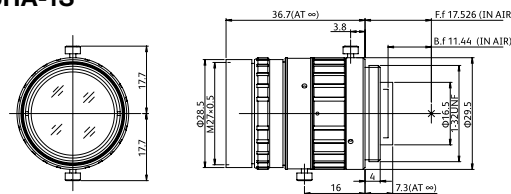

HF9HA-1S

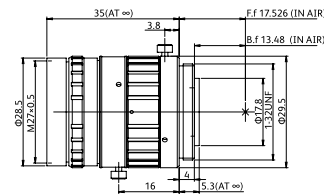

HF12.5HA-1S

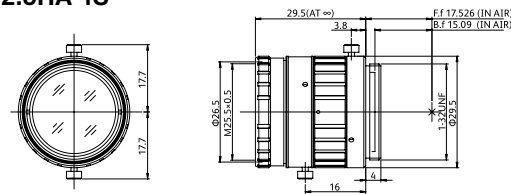

HF16HA-1S

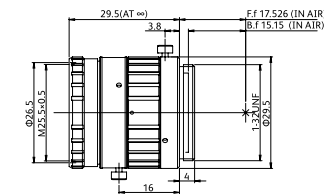

HF25HA-1S

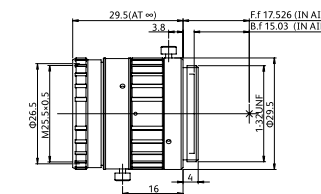

HF35HA-1S

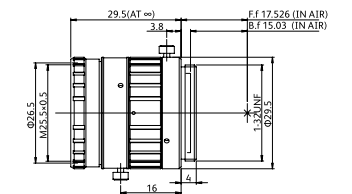

HF50HA-1S

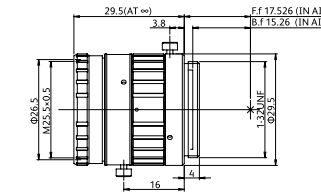

HF75HA-1S

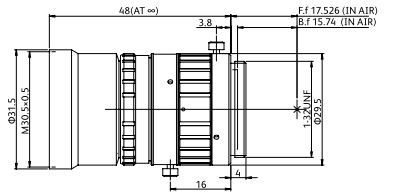

\*1 From front of lens barrel. \*2 Sensor size(std.): Ideal size to maximize the target resolution.

\*3 Sensor size(max.): Adaptable sensor size varies depending on the model. Please check the amount of light and resolution on the edges pertaining to your particular application.